

Angel Centre project update

Cllr Adem Mehmet - Cabinet Member for Infrastructure & Tonbridge Regeneration



Project objectives

- to provide a fit for purpose, state of the art, carbon neutral facility delivering high quality leisure/community facilities, replacing the existing building that is no longer fit for purpose
- to provide the right mix of high-quality accessible leisure/community facilities in the right location
- to ensure the facility can be adapted in the future to meet changes in the market
- reduce ongoing operational costs and generate new income
- to be carbon neutral
- to help facilitate wider development of the area east of the high street and increase footfall and investment in the town centre
- to secure the future of leisure facilities for the residents of Tonbridge and maintain continuity of service for residents

Timeline

We are here

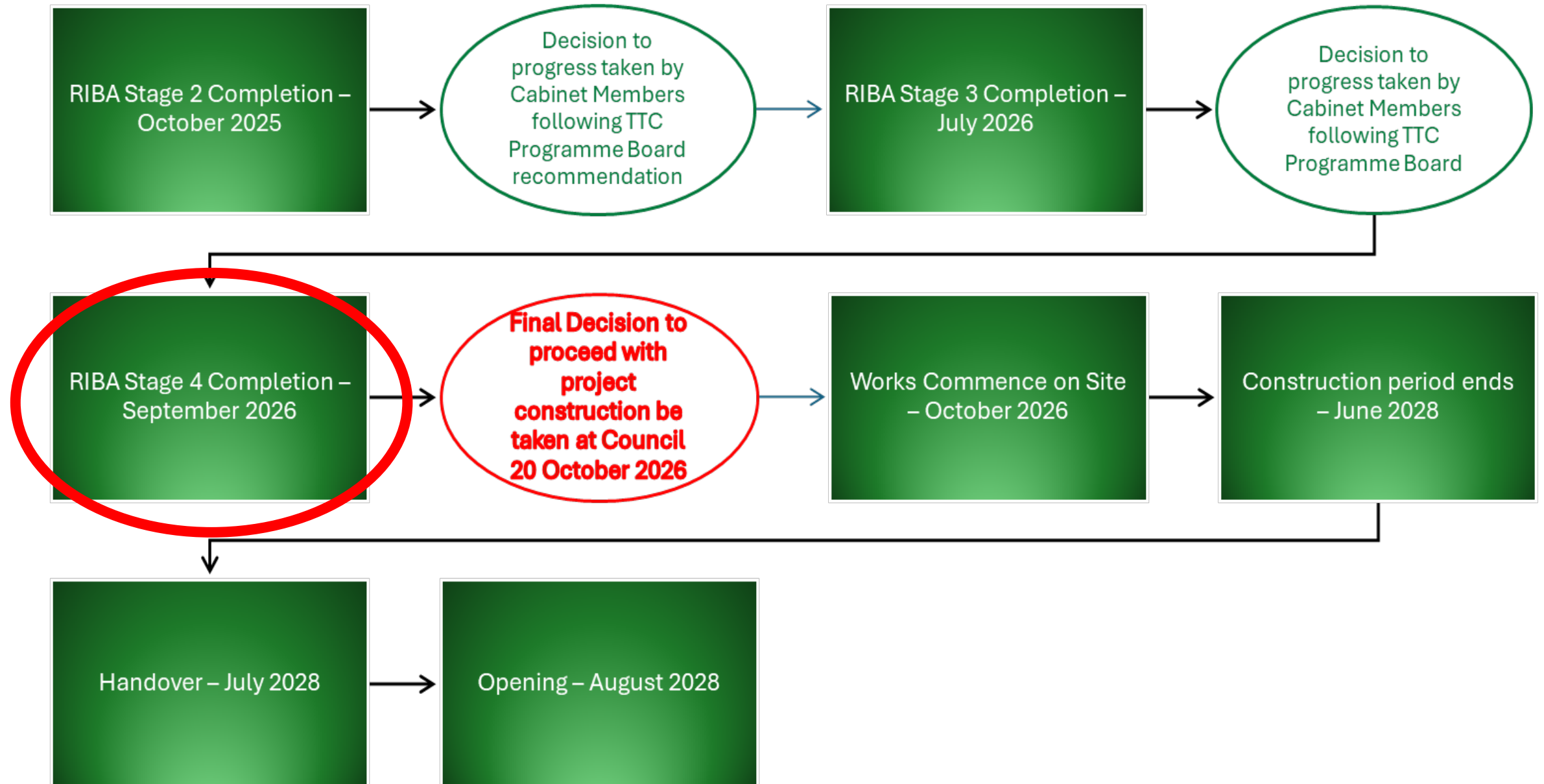

Consultation

16 February – 22 February public consultation pre submission

- ✓ 6,500 website visitors
- ✓ 700 attended exhibition in person
- ✓ 436 completed survey

- ✓ 68% in favour of scheme to provide new contemporary centre
- ✓ 56% think designs represent improvement on current facility
- ✓ Positive response to red brick exterior reflecting architectural character
- ✓ of Tonbridge

As a result of feedback new designs include:

- ✓ Remove dividing wall between studios - increase community event capacity
- ✓ Expanded gym
- ✓ Immersive spin studio
- ✓ Soft play and café



NEW!
Accessible + Spin Studio

 **Health and accessibility for all**
A strong message from our survey was the importance of dedicated exercise spaces for those with limited mobility.
We're introducing an Innerva 'Active Wellbeing' studio, featuring specially designed power-assisted equipment to ensure the new centre provides exercise opportunities for all.

 **Dedicated immersive spin studio**
Our new immersive spin studio will offer a great way to get your heart pumping with group cycling sessions.
The combination of motivational music and inspiring instructors makes spin a great way to push harder, get stronger and build stamina.

Scan for more info



Planning application

- March 2026 – Full planning application submitted
- Architects, [Saunders Boston](#) currently completing RIBA Stage 4 of the design - which is the technical refinement of the design.
- The planning application is due to be considered by full council on 14 July.

Issues arising from consultation

Footprint for the new Angel Centre

- Site location and scale of the new centre approved as part of Town Centre Masterplan.
- Analysis of current space found certain areas are underutilised.
- New plans incorporate multi-purpose studios that can accommodate a variety of activities from yoga to community events.
- Footprint large enough to deliver a modern, efficient, effective and flexible mix of spaces.

Meeting room capacity

- Looked at how existing spaces used, while building in flexibility for the future.
- Space now incorporates a retractable wall, to open-up studios 1 and 2 for larger groups.
- Space comparable in size to the Medway Hall - 235 square metres, capacity of 332 people.
- Hopeful to also improve capacity in Studio 3 – discussions with KFRS.

Issues arising from consultation (cont)

Meeting the needs of all the community

New centre takes an inclusive approach:

- New Active Wellbeing facility for those who may be less mobile, living with long-term health conditions or recovering from injury
- Flexible spaces that can be used for hobbyists, events and meetings
- Soft play facility
- Cafe where people of all ages can gather
- Lift, level access throughout and Changing Places facility
- Secure cycle parking
- Improved storage

Farmers Market

- Positive discussions with current owners to find suitable alternative location

New floor plans

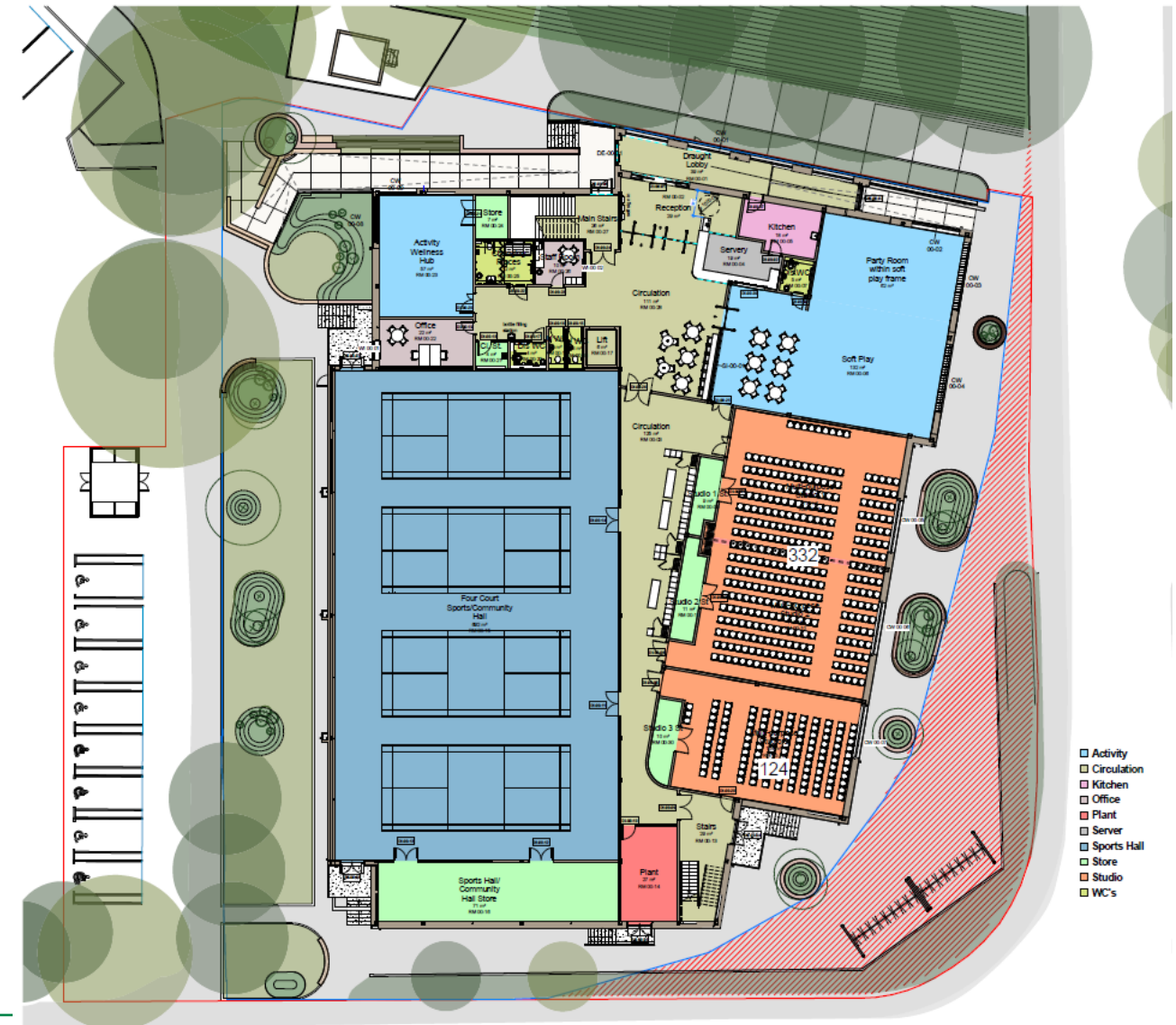
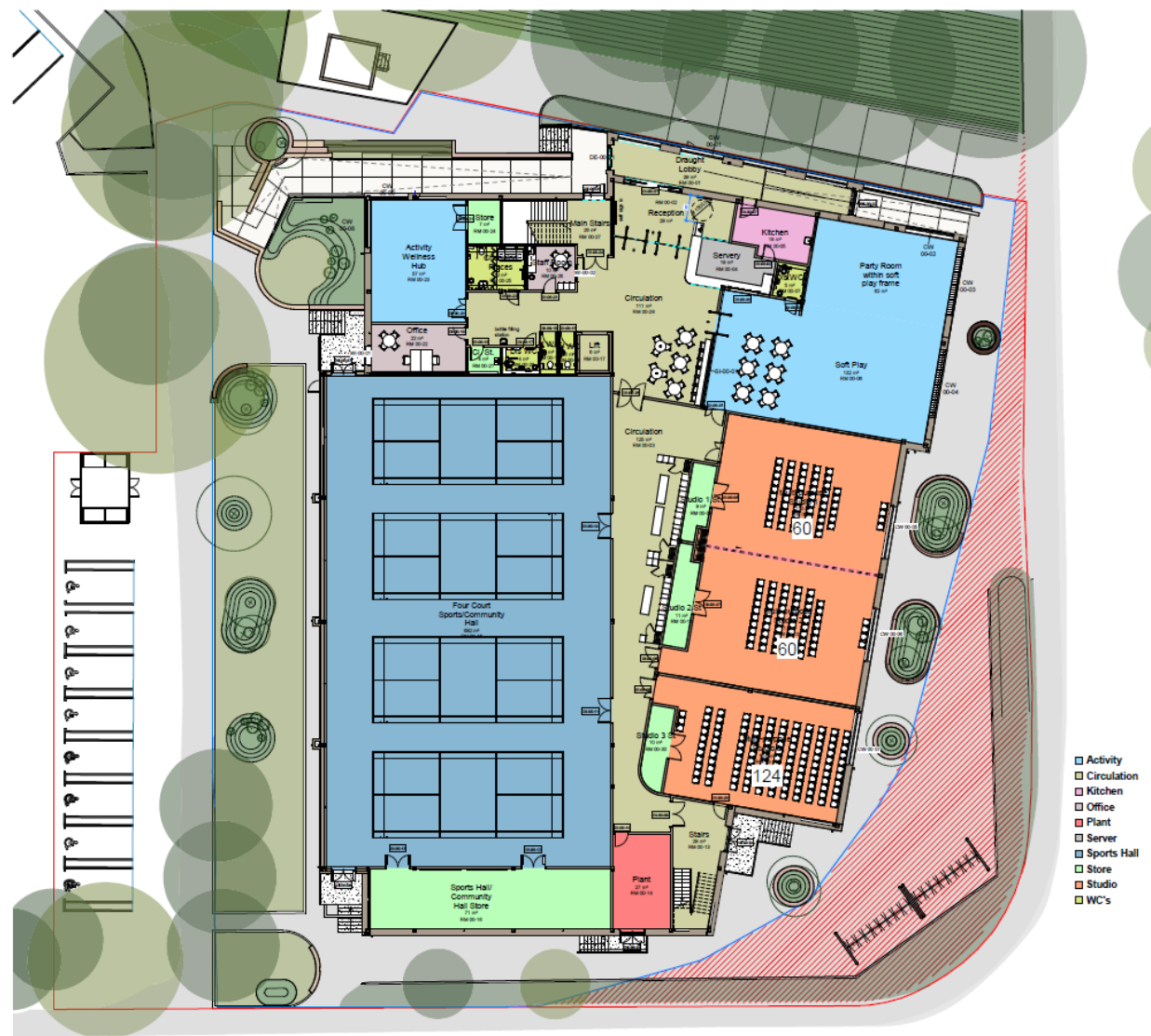

Next steps

- Continue to meet with community groups
- Planning Committee 14 July
- Website – angel-leisuredevelopment.co.uk and social media regularly updated
- Work begins October 2026